

JEITA Package Code	RENESAS Code	Previous Code	MASS (TYP.) [g]
P-SSOP30-0300-0.65	PRSP0030JD-A	S30MC-65-2A4-1	0.24

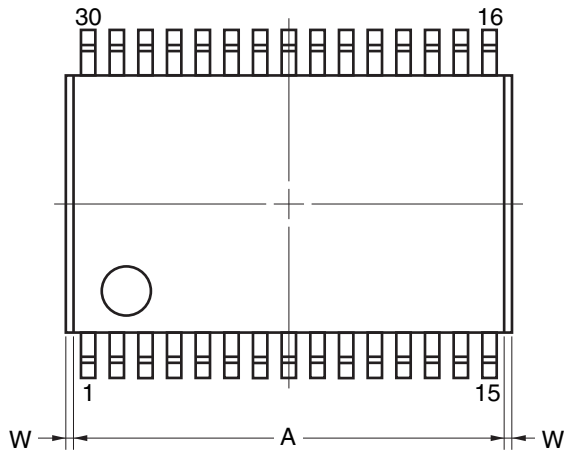

detail of lead end

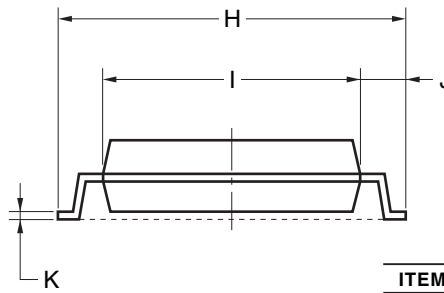
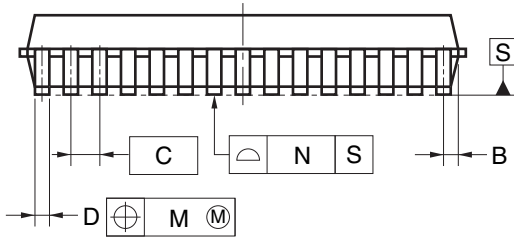
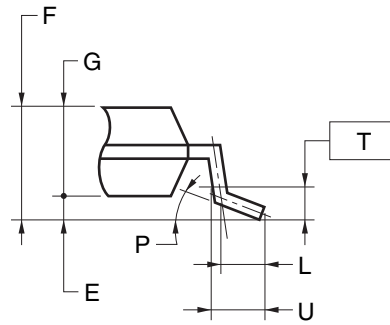

**NOTE**

Each lead centerline is located within 0.13 mm of its true position (T.P.) at maximum material condition.

ITEM	MILLIMETERS
A	9.70±0.10
B	0.30
C	0.65 (T.P.)
D	0.24 <sup>+0.08</sup> <sub>-0.07</sub>
E	0.10±0.05
F	1.95 MAX.
G	1.70±0.10
H	8.10±0.20
I	6.10±0.10
J	1.00±0.20
K	0.17±0.03
L	0.50
M	0.13
N	0.10
P	3° <sup>+5°</sup> <sub>-3°</sub>
T	0.25
U	0.60±0.15
W	0.15 MAX.