

# 52 PIN PLASTIC QFP (14x14)

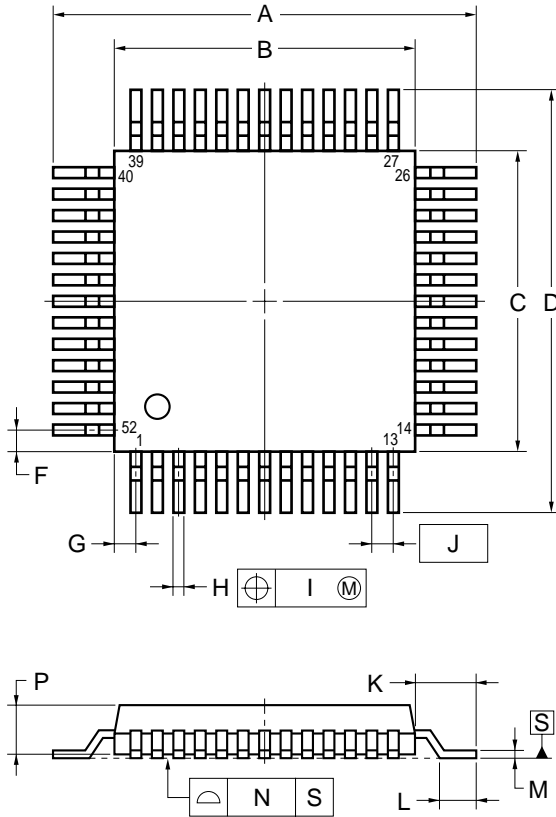

detail of lead end

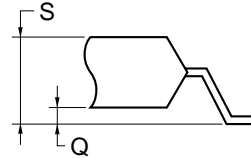

## NOTES

- Controlling dimension — millimeter.
- Each lead centerline is located within 0.20 mm of its true position (T.P.) at maximum material condition.

ITEM	MILLIMETERS	INCHES
A	21.0±0.4	0.827±0.016
B	14.0±0.2	0.551 <sup>+0.009</sup> <sub>-0.008</sub>
C	14.0±0.2	0.551 <sup>+0.009</sup> <sub>-0.008</sub>
D	21.0±0.4	0.827±0.016
F	1.0	0.039
G	1.0	0.039
H	0.42±0.08	0.017 <sup>+0.003</sup> <sub>-0.004</sub>
I	0.20	0.008
J	1.0 (T.P.)	0.039
K	3.5±0.2	0.138 <sup>+0.008</sup> <sub>-0.009</sub>
L	2.2±0.2	0.087 <sup>+0.008</sup> <sub>-0.009</sub>
M	0.17 <sup>+0.08</sup> <sub>-0.07</sub>	0.007 <sup>+0.003</sup> <sub>-0.004</sub>
N	0.15	0.006
P	2.6 <sup>+0.2</sup> <sub>-0.1</sub>	0.102 <sup>+0.009</sup> <sub>-0.004</sub>
Q	0.1±0.1	0.004±0.004
S	3.0 MAX.	0.119 MAX.