

EMBOSSED TAPE PACKING

Tape Dimensions

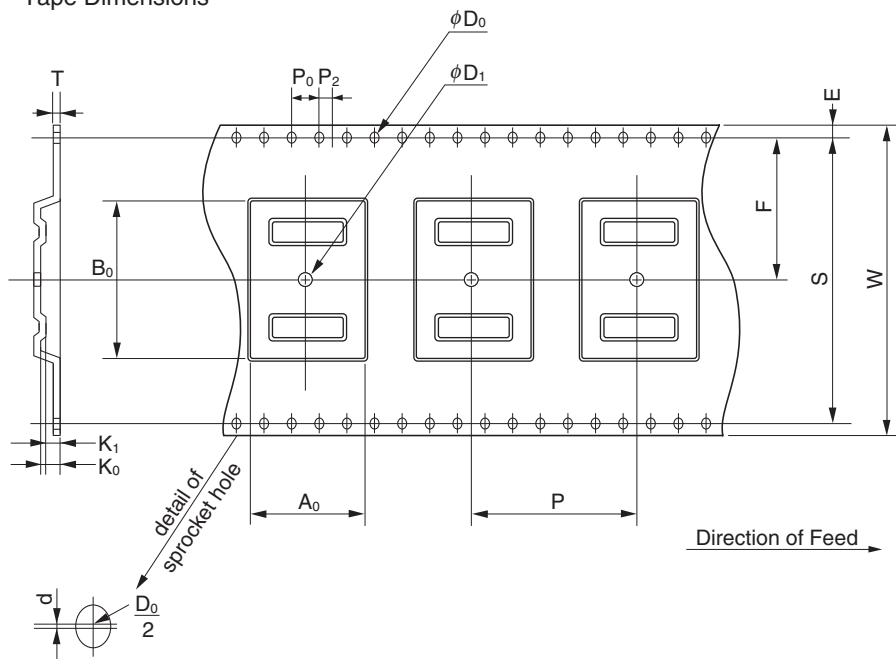

(Unit : mm)

Symbol	Specification
A_0	16.5
B_0	22.5
K_0	2.5
K_1	1.8
W	440.3
F	20.20.1
E	1.750.1
P	240.1
P_2	20.1
P_0	40.1
D_0	$1.5_{-0}^{+0.1}$
T	0.3
D_1	2 MIN.
S	40.40.1
d	0.20.05

Reel Dimensions

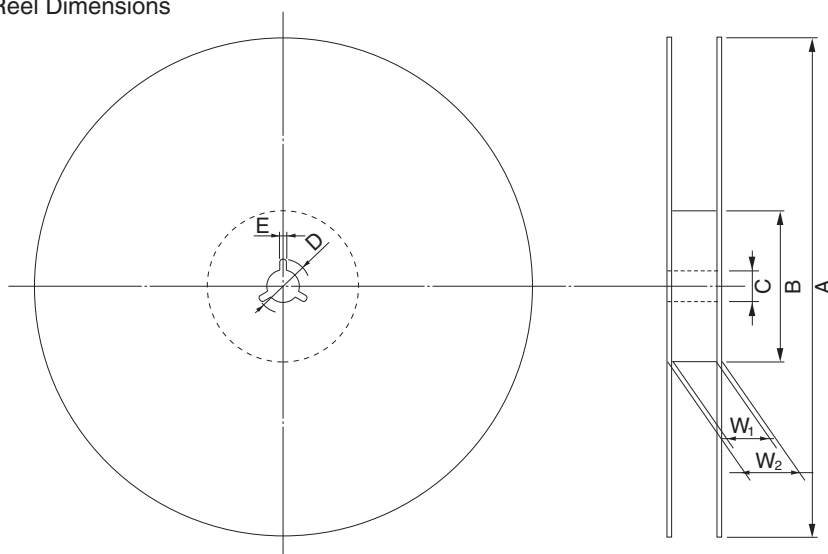

(Unit : mm)

Symbol	Specification
A	$\phi 3301.0$
B	$\phi 100$
C	$\phi 130.5$
D	$\phi 210.5$
E	20.5
W_1	45.5
W_2	49.5

Applied Package	Quantity (pcs)
100-pin Plastic LQFP (14x20, 1.4mm thick)	500, 1000 MAX.
128-pin Plastic LQFP (14x20, 1.4mm thick)	