

Hermetic Packages for Integrated Circuits

Package Outline Drawing

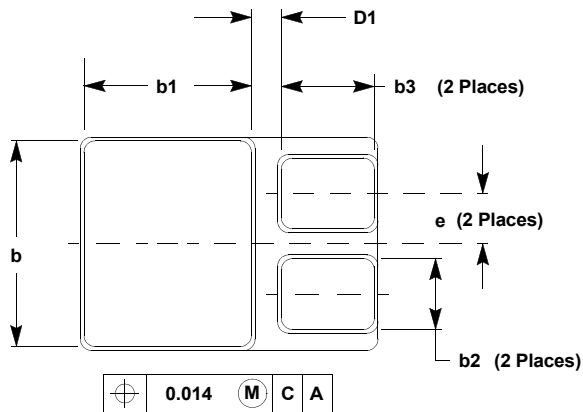
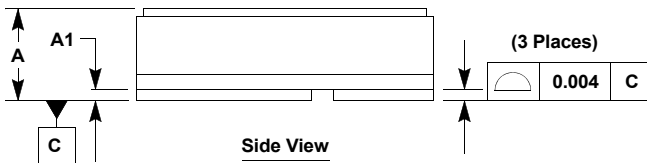
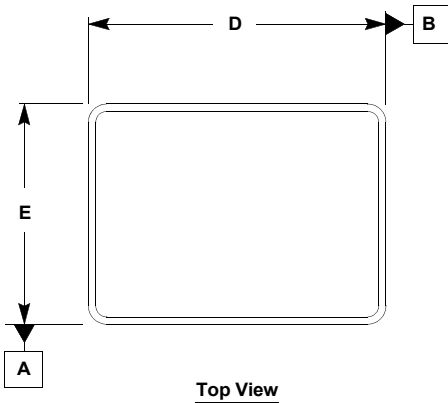

J3.A
3 Pad Hermetic SMD.5 Package
Bottom Terminal Ceramic Leadless Chip Carrier (CLCC)

Symbol	Inches		Millimeters		Notes
	Min	Max	Min	Max	
A	0.110	0.122	2.79	3.10	3
A1	0.010	0.020	0.25	0.51	-
b	0.281	0.291	7.13	7.39	-
b1	0.220	0.230	5.58	5.84	-
b2	0.090	0.100	2.28	2.54	-
b3	0.115	0.125	2.92	3.18	-
D	0.395	0.405	10.03	10.28	-
D1	0.030	-	0.76	-	-
E	0.291	0.301	7.39	7.64	-
e	0.075 BSC		1.91 BSC		-

Rev. 4 4/19

Notes:

- Controlling dimensions are in inches (mm for reference only).
- Dimensioning and tolerance per ANSI Y14.5M - 1982.
- The maximum "A" dimension is package height before being solder dipped.
- Patterned after MIL-STD-1835 CBCC1-N3 (C-B1). Note: Not meeting the Mil-Std "A" minimum dimension of 0.112.