

Top View

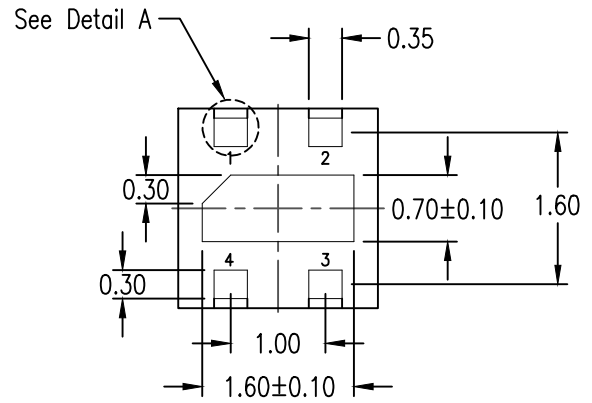

Bottom View

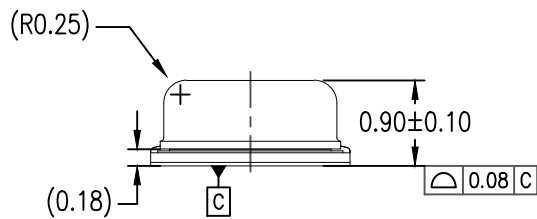

Side View

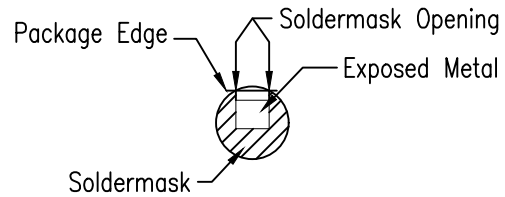

Detail A

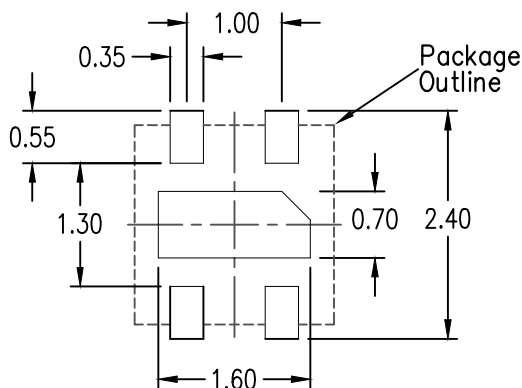

Recommended Land Pattern  
(PCB Top View SMD Design)

Notes:

1. JEDEC compatible
2. All dimensions are in mm and angles are in degrees
3. Use  $\pm 0.05$  mm tolerance for the untoleranced dimensions
3. Numbers in ( ) are for references only.

Package Revision History

Date Created	Rev No.	
Dec 17, 2020	00	Initial Release
July 6, 2021	01	Updated Bottom View
Aug 16, 2021	02	Changed Top View Port Hole Location
Nov 22, 2021	03	Updated Tolerance to non Geometric Dimension & Tolerance