

[Upgrade to Revision]  
 Solution Toolkit  
 AI Navigator V2.2.0: IDE for AI Applications

R20TS1240EJ0100  
 Rev.1.00  
 Jun. 20, 2026

Outline

AI Navigator, an IDE for AI applications, has been updated from V2.1.0 to V2.2.0.

1. Applicable Product

V2.1.0 of AI Navigator, an IDE for AI applications

2. Description

The main updates in this revision are listed in Section 2.1. For further details on these updates and the supported devices, refer to the release note at the link below.

- AI Navigator V2.2.0 Release Note  
<https://www.renesas.com/document/rln/ai-navigator-v220-release-note>

2.1 New features

- Added Support for Operating Systems
  - For the RA8 series, Linux (Ubuntu 22.04) is now supported. As in the Windows environment, you can run sample applications and perform model conversion using the RUHMI Framework for RA8 MCU (hereinafter referred to as RUHMI) with the Conversion Tool.
  - For the RZ/V series, the supported operating system has been updated to Ubuntu 22.04.

- Support for Model Visualizer

For the RA8 series, the Conversion Tool now supports Model Visualizer, which allows you to check the details of the converted AI model. You can check MAC/ROM/RAM usage and identify which layers are associated with Ethos or CPU.

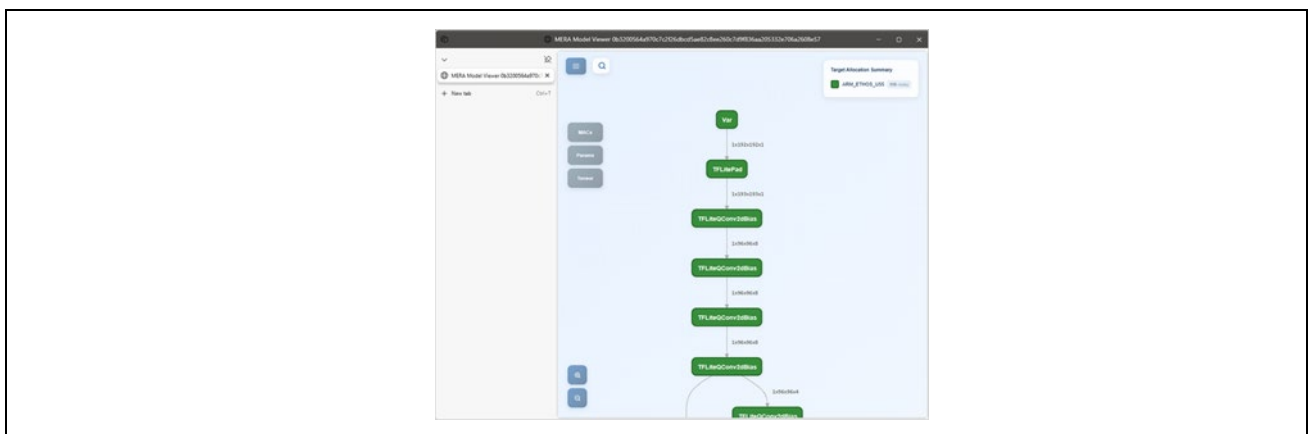

Figure 1 Model Visualizer

- Direct launch of Conversion Tool

You can now launch the Conversion Tool directly from the AI Navigator Home View.

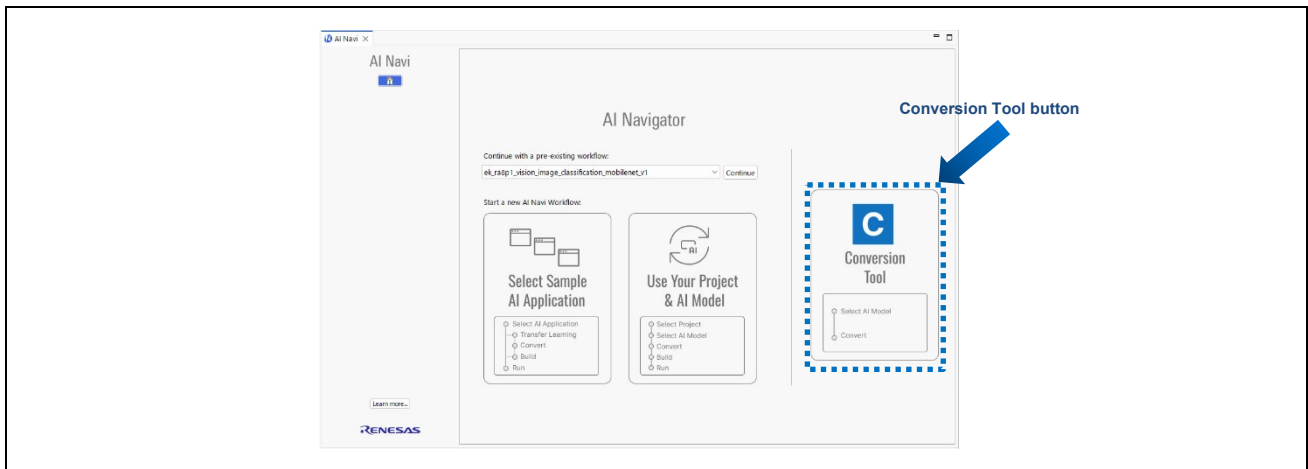

Figure 2 AI Navigator Home View

- Added support for AI Applications and AI SDKs
  - Support for RZ/V AI Application v7.10 has been added.
  - The following AI SDKs are now supported.
    - RZ/V2H AI SDK v6.00 (DRP-AI TVM v2.5.1)
    - RZ/V2N AI SDK v6.00, v6.30 (DRP-AI TVM v2.5.1)
    - RZ/V2L AI SDK v7.00 (DRP-AI TVM v2.6.1)

### 3. Installing and Using AI Navigator

To learn how to install and use AI Navigator, refer to the AI Navigator Quick Start Guide at the link below.

- RZ/V: [https://renesas-rz.github.io/rzv\\_ai\\_sdk/latest/ainavi\\_quick\\_start\\_guide](https://renesas-rz.github.io/rzv_ai_sdk/latest/ainavi_quick_start_guide) (GitHub)
- RA8: [Renesas RUHMI Framework\\*1 Quick Start Guide](#)

\*1 Powered by EdgeCortex® MERA™ 2.0

**Revision History**

Rev.	Date	Description	
		Page	Summary
1.00	Jun.20.26	-	First edition issued

Renesas Electronics has used reasonable care in preparing the information included in this document, but Renesas Electronics does not warrant that such information is error free. Renesas Electronics assumes no liability whatsoever for any damages incurred by you resulting from errors in or omissions from the information included herein.

The past news contents have been based on information at the time of publication. Now changed or invalid information may be included.

The URLs in the Tool News also may be subject to change or become invalid without prior notice.

**Corporate Headquarters**

TOYOSU FORESIA, 3-2-24 Toyosu,  
Koto-ku, Tokyo 135-0061, Japan  
[www.renesas.com](http://www.renesas.com)

**Trademarks**

Renesas and the Renesas logo are trademarks of Renesas Electronics Corporation. All trademarks and registered trademarks are the property of their respective owners.

**Contact Information**

For further information on a product, technology, the most up-to-date version of a document, or your nearest sales office, please visit:  
[www.renesas.com/contact/](http://www.renesas.com/contact/)