

TOP VIEW

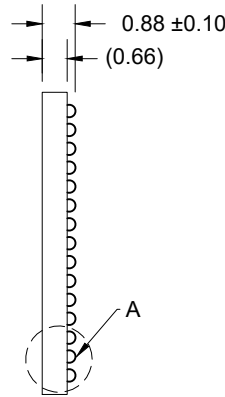

SIDE VIEW

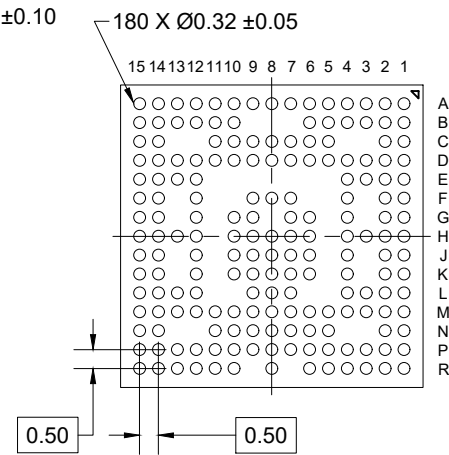

BOTTOM VIEW

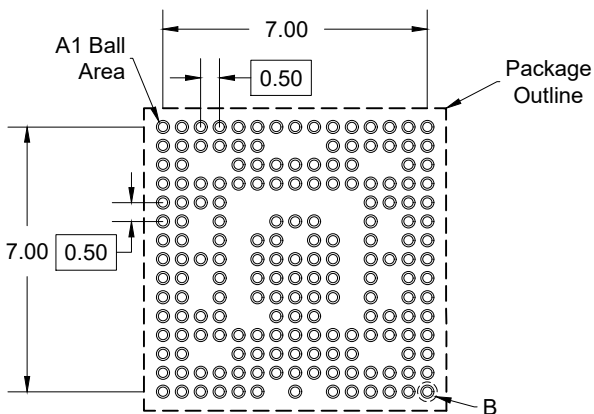

RECOMMENDED LAND PATTERN  
(PCB Top View, NSMD Design)

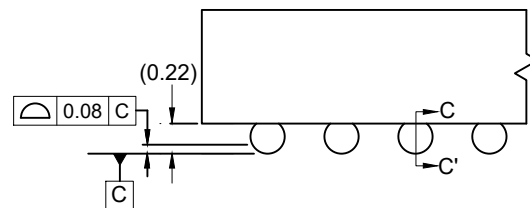

Detail A  
(Rotated 90° CW)

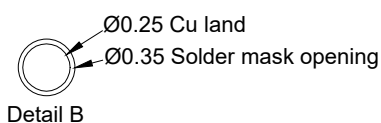
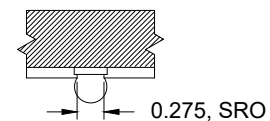

**NOTES:**

1. JEDEC compatible.
2. All dimensions are in mm and angles are in degrees.
3. Use ±0.05 mm for the non-toleranced dimensions.
4. Numbers in ( ) are for references only.
5. Pre-reflow solderball diameter is Ø0.3 mm.