



Integrated Device Technology, Inc.
6024 Silver Creek Valley Road, San Jose, CA 95138

PRODUCT/PROCESS CHANGE NOTICE (PCN)

PCN #: TB-0609-02 DATE: 06-Oct-2006 Product Affected: SOJ 28L, 32L, 36L Products shipped in tube Date Effective: 06-Jan-2007	MEANS OF DISTINGUISHING CHANGED DEVICES: <input type="checkbox"/> Product Mark <input type="checkbox"/> Back Mark <input type="checkbox"/> Date Code <input checked="" type="checkbox"/> Other Rev. 08 printed on shipping tube
-----------------------------------------------------------------------------------------------------------------------------------------------------------------------	-------------------------------------------------------------------------------------------------------------------------------------------------------------------------------------------------------------------------------------------------------------------------

Contact: Geoffrey Cortes Title: Product Quality Phone #: (408) 284-8321 Fax #: (408) 284-1450 E-mail: Geoffrey.Cortes@idt.com	Attachment: <input checked="" type="checkbox"/> Yes <input type="checkbox"/> No Samples: N/A
---------------------------------------------------------------------------------------------------------------------------------------------------------------------------------------------------------------------------	-------------------------------------------------------------------------------------------------------------------

DESCRIPTION AND PURPOSE OF CHANGE:

<input type="checkbox"/> Die Technology <input type="checkbox"/> Wafer Fabrication Process <input type="checkbox"/> Assembly Process <input type="checkbox"/> Equipment <input type="checkbox"/> Material <input type="checkbox"/> Testing <input type="checkbox"/> Manufacturing Site <input type="checkbox"/> Data Sheet <input checked="" type="checkbox"/> Other - Packing Material	<p>This notification is to advise our customer that IDT has qualified new shipping tubes for SOJ 28L, 32L, 36L products. The new shipping tubes have an increase in the tube opening height from 0.105 inches to 0.128 inches to provide better protection for packages during assembly, test and backend processes.</p> <p>Attachment I details the change. Attachment II provides a list of affected products.</p>
-----------------------------------------------------------------------------------------------------------------------------------------------------------------------------------------------------------------------------------------------------------------------------------------------------------------------------------------------------------------------------------------------------------------	--------------------------------------------------------------------------------------------------------------------------------------------------------------------------------------------------------------------------------------------------------------------------------------------------------------------------------------------------------------------------------------------------------------------------

RELIABILITY/QUALIFICATION SUMMARY:

The new shipping tubes have passed IDT qualification. Please see Attachment I for the qualification results.

CUSTOMER ACKNOWLEDGMENT OF RECEIPT:

IDT records indicate that you require written notification of this change. Please use the acknowledgement below or E-Mail to grant approval or request additional information. If IDT does not receive acknowledgement within 30 days of this notice it will be assumed that this change is acceptable.

IDT reserves the right to ship either version manufactured after the process change effective date until the inventory on the earlier version has been depleted.

Customer: _____	<input type="checkbox"/> <i>Approval for shipments prior to effective date.</i>
Name/Date: _____	E-Mail Address: _____
Title: _____	Phone # /Fax #: _____

CUSTOMER COMMENTS: _____

IDT ACKNOWLEDGMENT OF RECEIPT:

RECD. BY: _____ DATE: _____



Integrated Device Technology, Inc.
6024 Silver Creek Valley Road, San Jose, CA 95138

PRODUCT/PROCESS CHANGE NOTICE (PCN)

ATTACHMENT I - PCN #: TB-0609-02

PCN Type: Packing

Data Sheet Change: None

Detail of Change: This notification is to advise our customer that IDT has qualified new shipping tubes for SOJ 28L, 32L, 36L products. The new shipping tubes have an increase in the tube opening height from 0.105 inches to 0.128 inches to provide better protection for packages during assembly, test and backend processes.

The new shipping tubes have passed IDT's internal qualification requirements.

Description	Existing Shipping Tube	New Shipping Tube
Supplier	ITW Meritex	ITW Meritex
Supplier Part Number	O-XT0687 Rev 07	O-XT0687 Rev 08
IDT Part Number	P1-069-000 Rev 07	P1-069-000 Rev 08
Revision Printed on Tube	Rev. 07	Rev. 08
* Tube Opening Height (inches)	0.105	0.128

** Note: Tube opening height is denoted as dimension 'F' in the tube drawing. See attachment for the drawing.*

Qualification Plan #: BC06-09-08

Qualification Test Plan and Result:

Test Vehicle: SOJ 36L

Qualification Test and Conditions	Reject / Sample Size	Result
6 Feet Drop Test (6 drops, 1 drop per side @ standard packing)	0/10 tubes	Pass
Manufacturability (IC Fitting, Trim & Form Machine, Vision System, Test Handler)	0/10 tubes	Pass
Visual/Mechanical (Chip, crack, pit, incomplete fill, contamination, burr on tray pocket)	0/5 tubes	Pass
Static Electricity Test (100 volts max)	0/5 tubes	Pass
Dimensional (critical dimensions based on drawing)	0/5 tubes	Pass



Integrated Device Technology, Inc.
6024 Silver Creek Valley Road, San Jose, CA 95138

PRODUCT/PROCESS CHANGE NOTICE (PCN)

ATTACHMENT II - PCN #: TB-0609-02

Affected Part Number

IDT Part Number	IDT Part Number	IDT Part Number	IDT Part Number
IDT71024S12Y	IDT71124S12YGI	IDT71V124SA10YI	IDT71V424S12Y
IDT71024S12YG	IDT71124S12YI	IDT71V124SA12Y	IDT71V424S12YG
IDT71024S12YGI	IDT71124S15Y	IDT71V124SA12YG	IDT71V424S12YGI
IDT71024S12YI	IDT71124S15YG	IDT71V124SA12YGI	IDT71V424S12YI
IDT71024S15Y	IDT71124S15YGI	IDT71V124SA12YI	IDT71V424S15Y
IDT71024S15YG	IDT71124S15YI	IDT71V124SA15Y	IDT71V424S15YG
IDT71024S15YGI	IDT71124S20Y	IDT71V124SA15YG	IDT71V424S15YGI
IDT71024S15YI	IDT71124S20YG	IDT71V124SA15YGI	IDT71V424S15YI
IDT71024S20Y	IDT71124S20YGI	IDT71V124SA15YI	IDT71V428L10Y
IDT71024S20YG	IDT71124S20YI	IDT71V124SA20Y	IDT71V428L10YG
IDT71024S20YGI	IDT71128S12Y	IDT71V124SA20YI	IDT71V428L10YGI
IDT71024S20YI	IDT71128S12YG	IDT71V424L10Y	IDT71V428L12Y
IDT71024S25Y	IDT71128S12YGI	IDT71V424L10YG	IDT71V428L12YI
IDT71024S25YG	IDT71128S12YI	IDT71V424L10YGI	IDT71V428L15Y
IDT71028S12Y	IDT71128S15Y	IDT71V424L10YI	IDT71V428L15YI
IDT71028S12YG	IDT71128S15YG	IDT71V424L12Y	IDT71V428S10Y
IDT71028S12YI	IDT71128S15YGI	IDT71V424L12YG	IDT71V428S10YGI
IDT71028S15Y	IDT71128S15YI	IDT71V424L12YGI	IDT71V428S10YGI
IDT71028S15YG	IDT71128S20Y	IDT71V424L12YI	IDT71V428S10YI
IDT71028S15YGI	IDT71128S20YG	IDT71V424L15Y	IDT71V428S12Y
IDT71028S15YI	IDT71128S20YGI	IDT71V424L15YG	IDT71V428S12YG
IDT71028S20Y	IDT71128S20YI	IDT71V424L15YGI	IDT71V428S12YGI
IDT71028S20YG	IDT71V124S15Y	IDT71V424L15YI	IDT71V428S12YI
IDT71028S20YGI	IDT71V124S20Y	IDT71V424S10Y	IDT71V428S15Y
IDT71028S20YI	IDT71V124SA10Y	IDT71V424S10YG	IDT71V428S15YGI
IDT71124S12Y	IDT71V124SA10YG	IDT71V424S10YGI	IDT71V428S15YGI
IDT71124S12YG	IDT71V124SA10YGI	IDT71V424S10YI	IDT71V428S15YI

REVISIONS				
REV	DESCRIPTION	DATE	APPROVED	
13	INCLUDED ITW MERITEX AS SUPPLIER	03/11/06	KK Three	
14	INCREASE (F) FROM 0.105" TO 0.128"	08/24/06	KK Three	

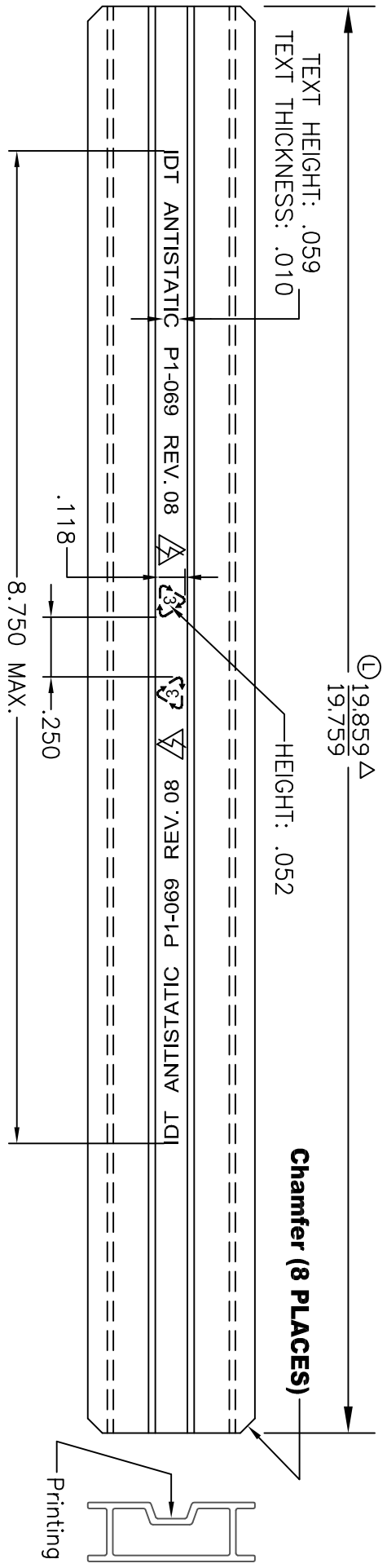

TUBE COLOUR:	CLEAR
PRINT COLOUR:	DARK BLUE

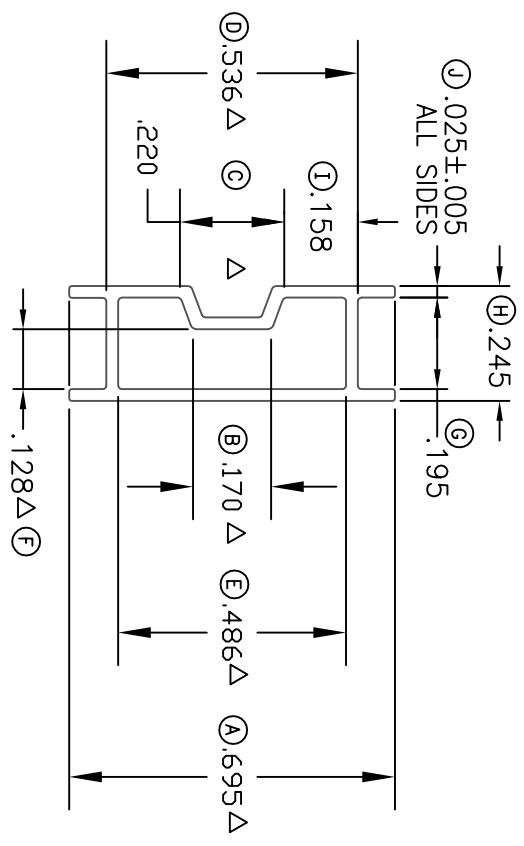

- NOTES : (UNLESS OTHERWISE SPECIFIED)
1. ALL DIMENSIONS ARE INCHES, UNLESS OTHERWISE SPECIFIED.
 2. ALL TUBE TOLERANCE TO BE ± 0.010", UNLESS OTHERWISE SPECIFIED.
 3. AT LEAST ONE COMPLETE PRINT PER TUBE
 4. REFER TO MSA-3049 FOR MATERIAL & COATING REQUIREMENTS
 5. END TO BE 0.010" BURR ALLOWABLE.
 6. * DENOTES CRITICAL DIMENSION.
 7. SUPPLIER PART NUMBER :
 8. IDT PART NUMBER FOR PINK TUBE : R1-069-000
 9. PRINTING REVISION : REV 08
 10. PRODUCE WITH DRY EXTRUSION PROCESS.

TOLERANCES UNLESS OTHERWISE SPECIFIED
 DECIMAL .05
 .XX ±.13
 .XXX ±.15

ANGLE ±.5°

APPROVALS DATE

DRAWN

CHECKED

TITLE: PB/PBG 28/32/36 SHIPPING TUBE

STOCK NO. P1-069-000

DRAWING NO. MSC-3026

SCALE N/A

REV B

REV 14

FILE: MSC1701

DO NOT SCALE DRAWING

SHEET 1 OF 1

IDT 6024 Silver Creek Valley Road, San Jose, CA 95138
 PHONE: (408) 284-8200
 FAX: (408) 284-3572
 www.IDT.com