

# SON, HSON

## Mount Pad Dimensions

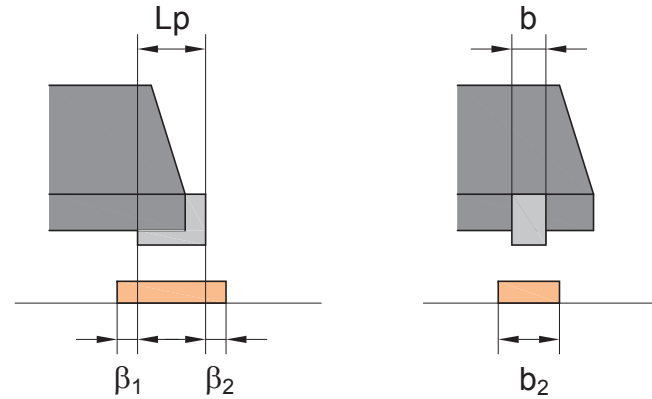
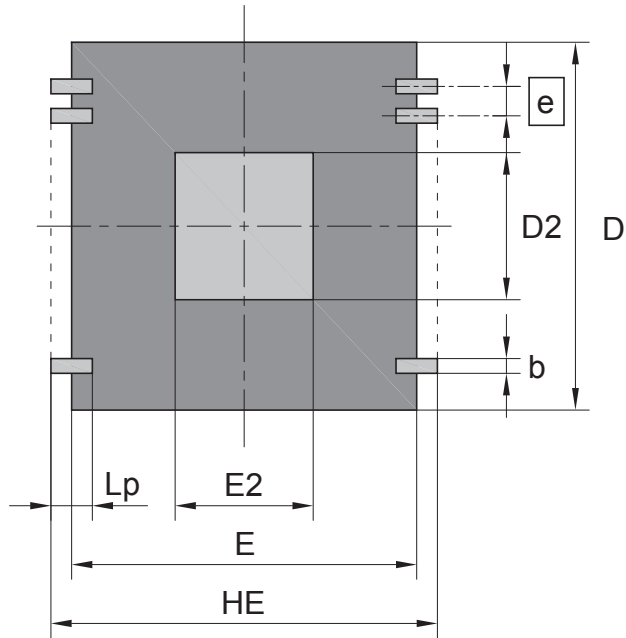

$$l_2 = L + \beta_1 + \beta_2$$

$$b \leq b_2 \leq e - \gamma$$

$L_p$  = Leadlength  
 $b$  = Leadwidth

$l_2$  and  $b_2$  can get by following formula and value  $e$  and  $b$  from package drawing figure and below parameter table.

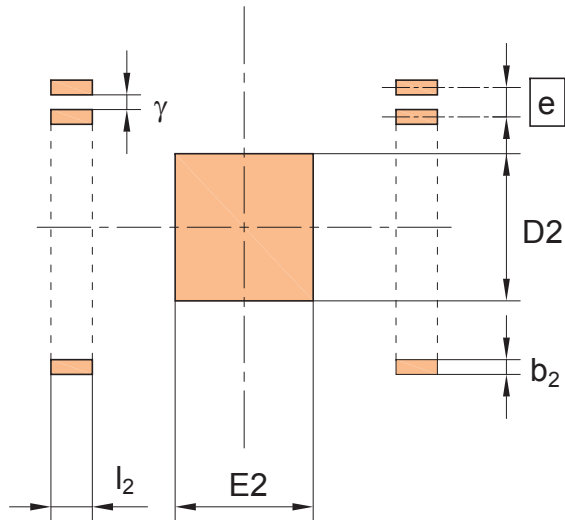

• Dimension parameter (Unit: mm)

e	0.65	0.50
$\beta_1$	0 to 0.30	0 to 0.30
$\beta_2$	0 to 0.30	0 to 0.30
$\gamma$	0.10 to 0.30	0.10 to 0.30

(Reference value)

Note

In case to use thermal pad, the size of thermal pad should be the same as the diepad.