

# EMBOSS TAPE CONTAINER

## Tape Dimensions

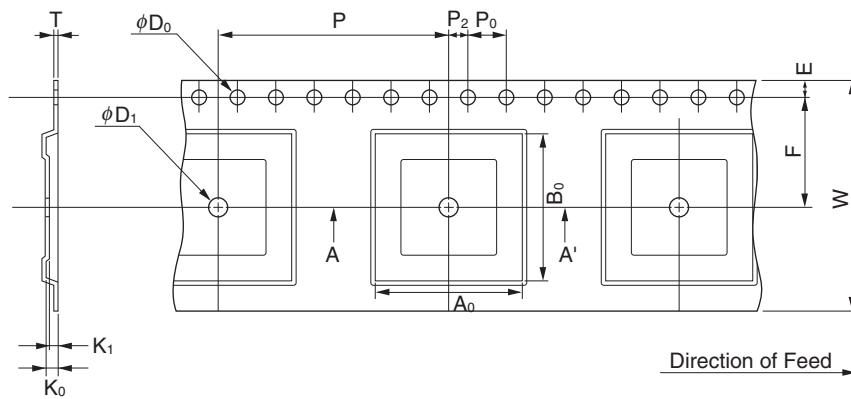

(Unit : mm)

Symbol	Specification
A <sub>0</sub>	16.35
B <sub>0</sub>	16.35
K <sub>0</sub>	1.7
K <sub>1</sub>	1.3
W	24.0±0.3
F	11.5±0.1
E	1.75±0.1
P	24.0±0.1
P <sub>2</sub>	2.0±0.1
P <sub>0</sub>	4.0±0.1
D <sub>0</sub>	1.5 <sup>+0.1</sup> <sub>0</sub>
T	0.3
D <sub>1</sub>	2.0 MIN.
A <sub>R2</sub>	1.0
B <sub>R2</sub>	1.0

<SECTION A-A'>

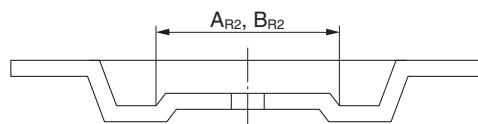

## Reel Dimensions

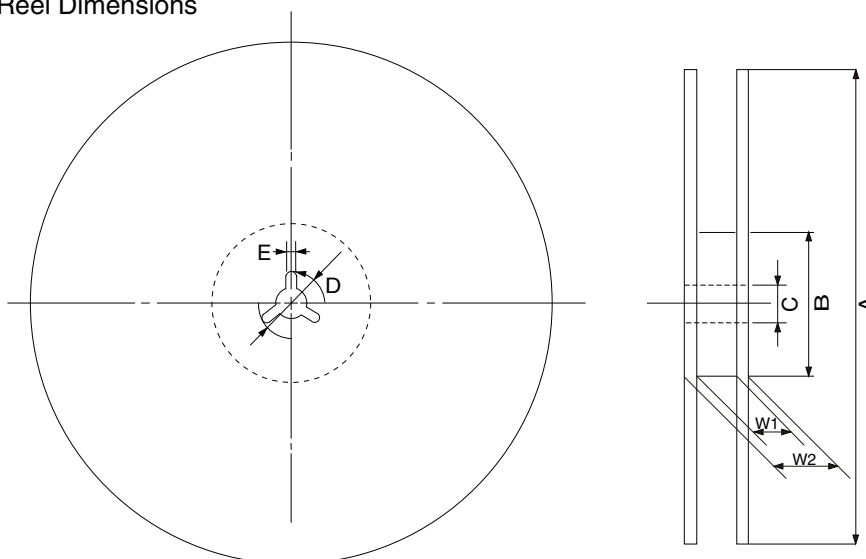

(Unit: mm)

Symbol	Specification
A	φ330±2.0
B	φ100
C	φ13.0±0.2
D	φ21.0±0.8
E	2.0±0.5
W <sub>1</sub>	25.5
W <sub>2</sub>	29.5±1.0

Applied Package	Quantity (pcs)
100-pin Plastic TQFP (1.0mm thick)	MAX. 1,000