

JEITA Package Code	RENESAS Code	Previous Code	MASS (TYP.) [g]
P-LFQFP176-20x20-0.40	PLQP0176LC-C	S176GJ-40-UEV-1	1.87

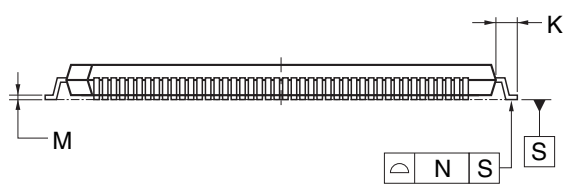
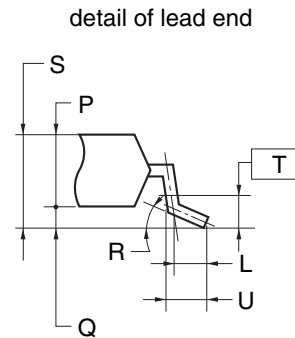
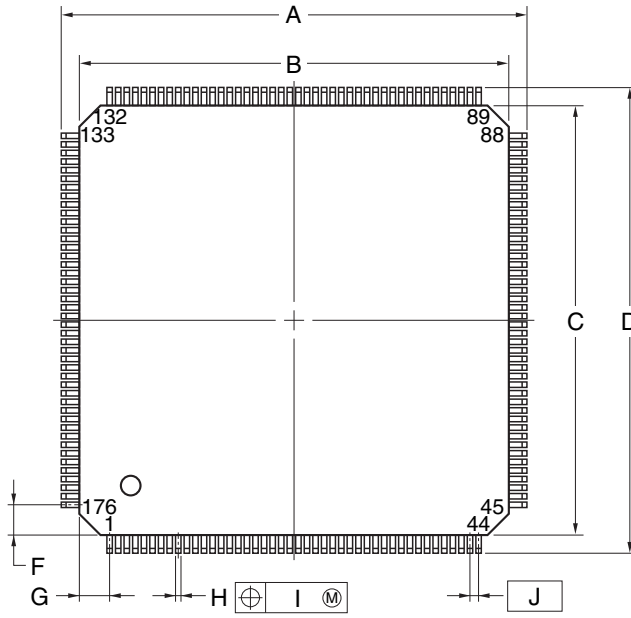

ITEM	MILLIMETERS
A	22.00±0.20
B	20.00±0.20
C	20.00±0.20
D	22.00±0.20
F	1.40
G	1.40
H	0.18±0.05
I	0.07
J	0.40 (T.P.)
K	1.00±0.15
L	0.50
M	0.17±0.03
N	0.08
P	1.40
Q	0.10±0.05
R	3°+4° -3°
S	1.50±0.1
T	0.25
U	0.60±0.15

**NOTE**  
Each lead centerline is located within 0.07 mm of its true position (T.P.) at maximum material condition.